

# Oil Analyzers INC.

## HOW TO GUIDE #4:

### Submitting Samples Using the HORIZON® APP

---

**SUMMARY:** When access to a computer is not readily available, you can submit your sample information through the **HORIZON Fluid Analysis Results** mobile app.

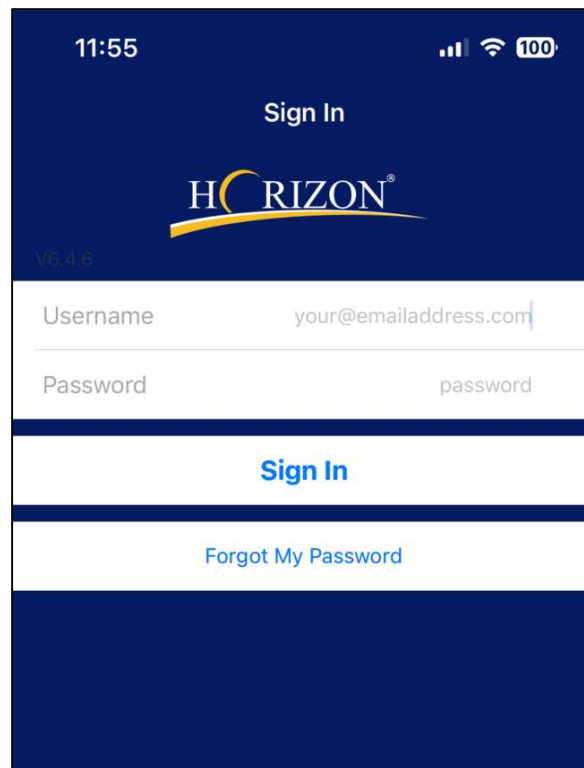

1. Log in to the app using your HORIZON login credentials (username and password)
2. Begin by tapping the three bars in the upper left.

# Oil Analyzers INC.

## HOW TO GUIDE #4:

### Submitting Samples Using the HORIZON® APP

---

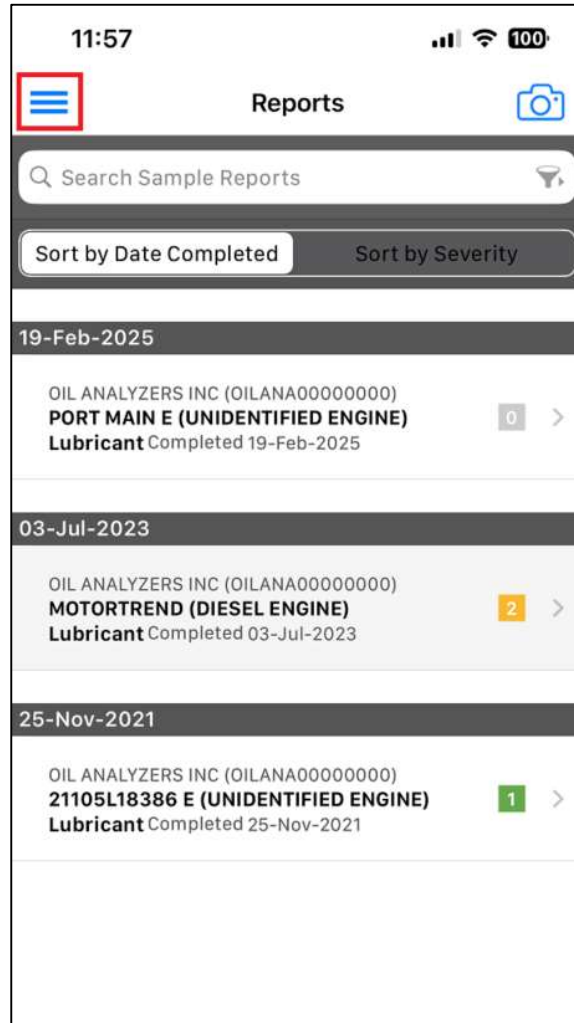

# Oil Analyzers INC.

## HOW TO GUIDE #4:

### Submitting Samples Using the HORIZON® APP

---

3. Tap “Submissions” to start a new submission or view previously submitted samples.

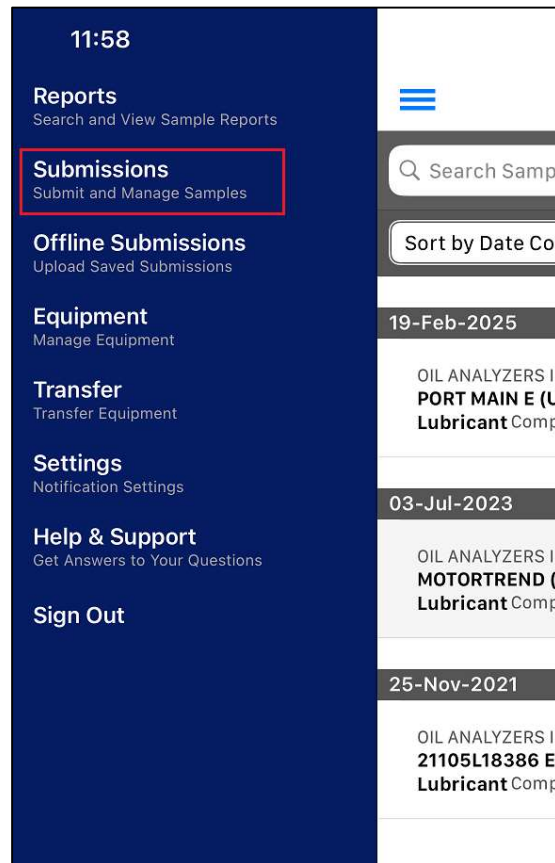

This section will show a list of samples you’ve previously submitted, if any.

## HOW TO GUIDE #4:

### Submitting Samples Using the HORIZON® APP

---

4. To submit a new sample, tap “New” in the upper right.

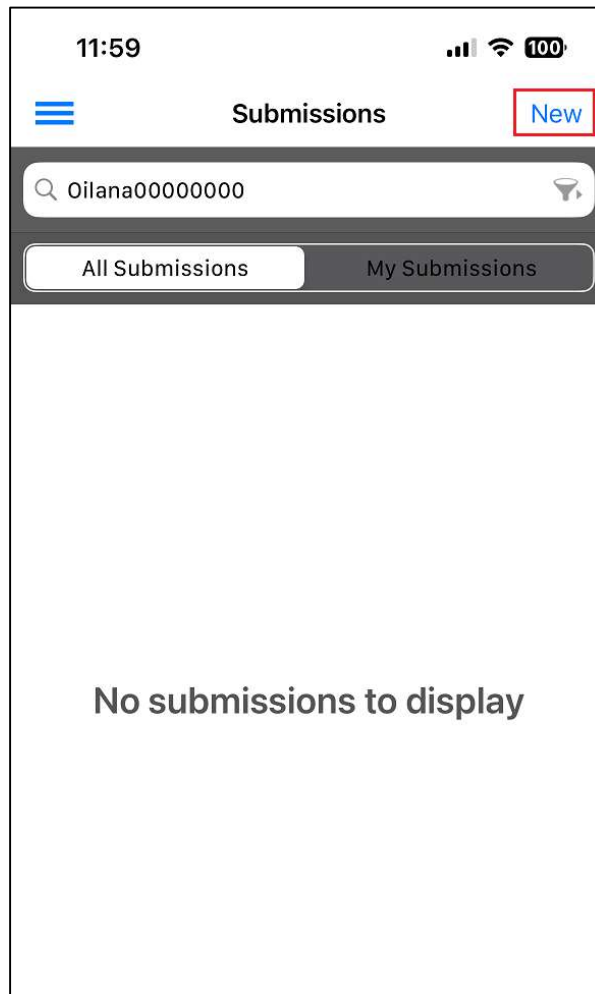

5. Enter the 11-digit sample number from your sample form. You may either enter the number manually or scan the QR code on the sample form by tapping the camera icon.



00000A00000

# Oil Analyzers INC.

## HOW TO GUIDE #4:

### Submitting Samples Using the HORIZON® APP

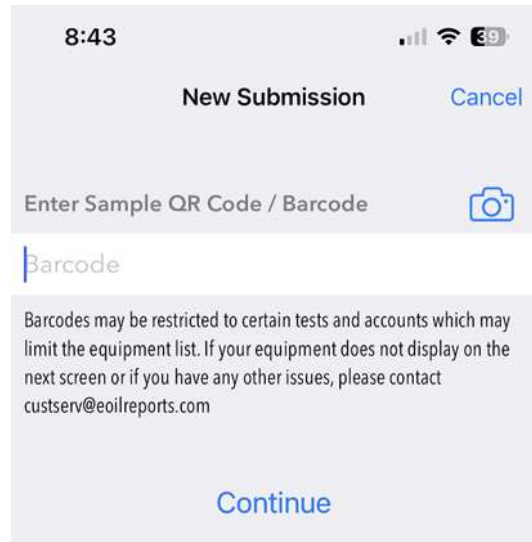

6. After the sample number is entered, you will see your equipment list, along with the type of kit and the fluid types you can test with the kit. Select the component or equipment for which you are submitting a sample.

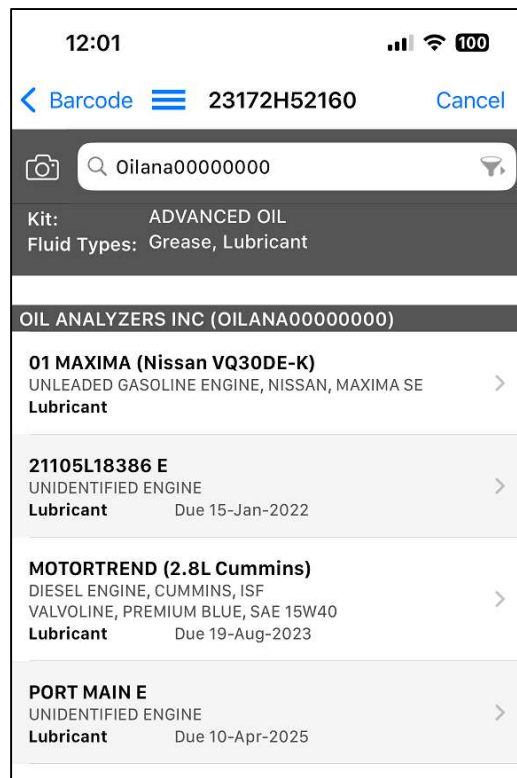

## HOW TO GUIDE #4:

### Submitting Samples Using the HORIZON® APP

7. After selecting the component, the sample information can be entered. This consists of the following:
  - 7.1. **Component Time** – Total time or mileage on the equipment.
  - 7.2. **Fluid Time** – Time or mileage on the sample.
  - 7.3. **Filter and Fluid Change** – Indicates whether the filter or fluid was changed at the time the sample was taken.
  - 7.4. **Amount Added** – Enter the amount of fluid added since the last sample was taken or the oil was changed.

The screenshot displays the 'Components' screen in the HORIZON APP. At the top, the time is 12:02, and the signal strength, Wi-Fi, and battery (100%) icons are visible. Below the status bar, there is a navigation bar with a back arrow, the text 'Components 23172H52160', and a 'Cancel' button. The main content area is divided into several sections: 'COMPONENT INFORMATION' showing 'OIL ANALYZERS INC (OILANA00000000)' and '01 MAXIMA (Nissan VQ30DE-K) UNLEADED GASOLINE ENGINE, NISSAN, MAXIMA SE Lubricant'; 'SAMPLE INFORMATION' with 'Date Sampled \*' set to '19-Mar-2025' and a note '\* required for submission'; 'Component Time' and 'Fluid Time' fields, each with an 'Enter Time' button and a 'Miles' label; 'Filter Changed \*' and 'Fluid Changed \*' fields, each with a 'Choose One' label; 'Amount Added' field with an 'Enter Amo...' button and a 'Quarts' label; and 'ORDER INFORMATION' with 'Kit' set to 'ADVANCED OIL' and a 'Purchase Order #' field with an 'Enter PO #' label.

# Oil Analyzers INC.

## HOW TO GUIDE #4:

### Submitting Samples Using the HORIZON® APP

---

8. Once all information is entered, hit Submit at the bottom and you will receive a sample-submitted notification.

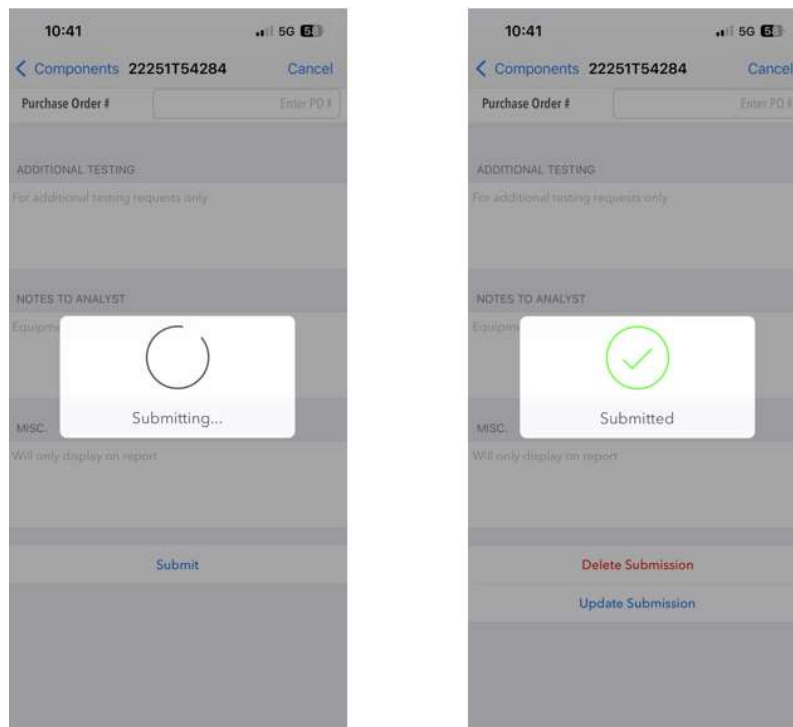

9. This completes the mobile-submission process. Your sample can now be sent to the lab. No paperwork is required when the information is submitted through the mobile app. Just be sure to attach the “Apply to Sample” QR sticker to the sample bottle and fill in the Equipment ID number.